

ITEM 1  
TUBE JOINER

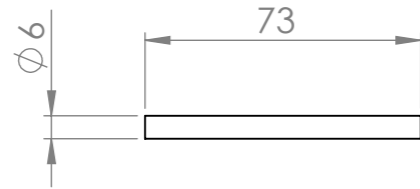

ITEM 2  
SHORT TUBE

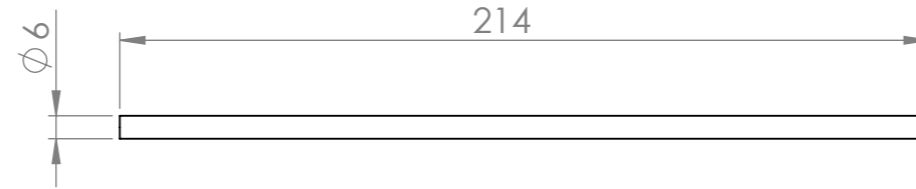

ITEM 3  
LONG TUBE



ITEM 4  
TUBE END BAND



ITEM 5  
JIB TACK FITTING

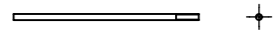

ITEM 6  
BALANCE ROD

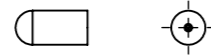

ITEM 7  
BALANCE WIEGHT



ITEM 8  
'O' RING



ITEM 9 x3  
BOOM BAND



ITEM 10  
SHEET LEAD



ITEM 11  
CLEW RING

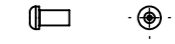

ITEM 12  
TUBE END FITTING



ITEM 13 x3  
BOWSIE

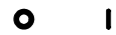

ITEM 14  
RIGGING RING

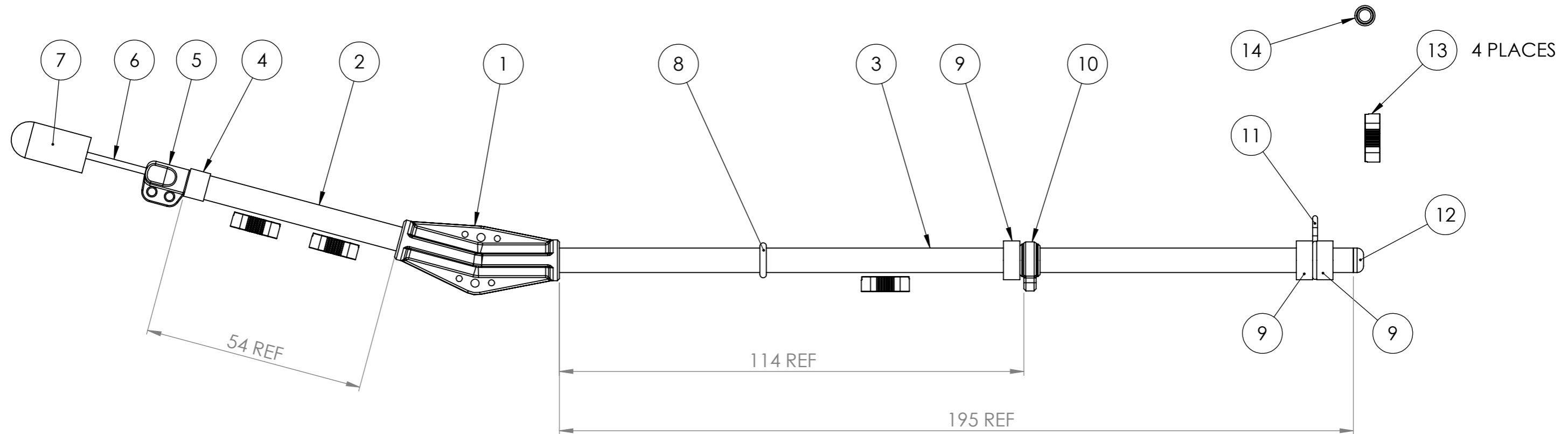

NOTES

1. APPLY A SMALL QAUNTITY OF YOUR CHOSEN ADHESIVE TO THE END OF, ITEM 2, SHORT TUBE AND INSERT INTO ITEM 1, TUBE JOINER. REPEAT WITH, ITEM 3, LONG TUBE, AND ALLOW TO SET.
2. APLY A DAB OF ADHESIVE TO THE FREE END OF, ITEM 2, SHORT TUBE, AND SLIDE, ITEM 4, TUBE END BAND IN PLACE AS INDICATED IN DRAWING.
3. ITEM 5 JIB TACK FITTING CAN BE GLUED IN PLACE BUT IS NOT ESSENTIAL.
4. DO NOT APPLY GLUE TO ITEM 12 ,TUBE END FITTING, UNTILL BOOM UPHAUL CONTROL LINE, IS ADDED. SEE STANDARD RIG ASSEMBLY INSTUCTIONS.

# DF95 JIB BOOM KIT 'B' ASSEMBLY